

**BOUNDARY MAP**  
**COMMUNITY FACILITIES DISTRICT NO. 2016-4**  
**CITY OF BEAUMONT**  
**COUNTY OF RIVERSIDE, STATE OF CALIFORNIA**

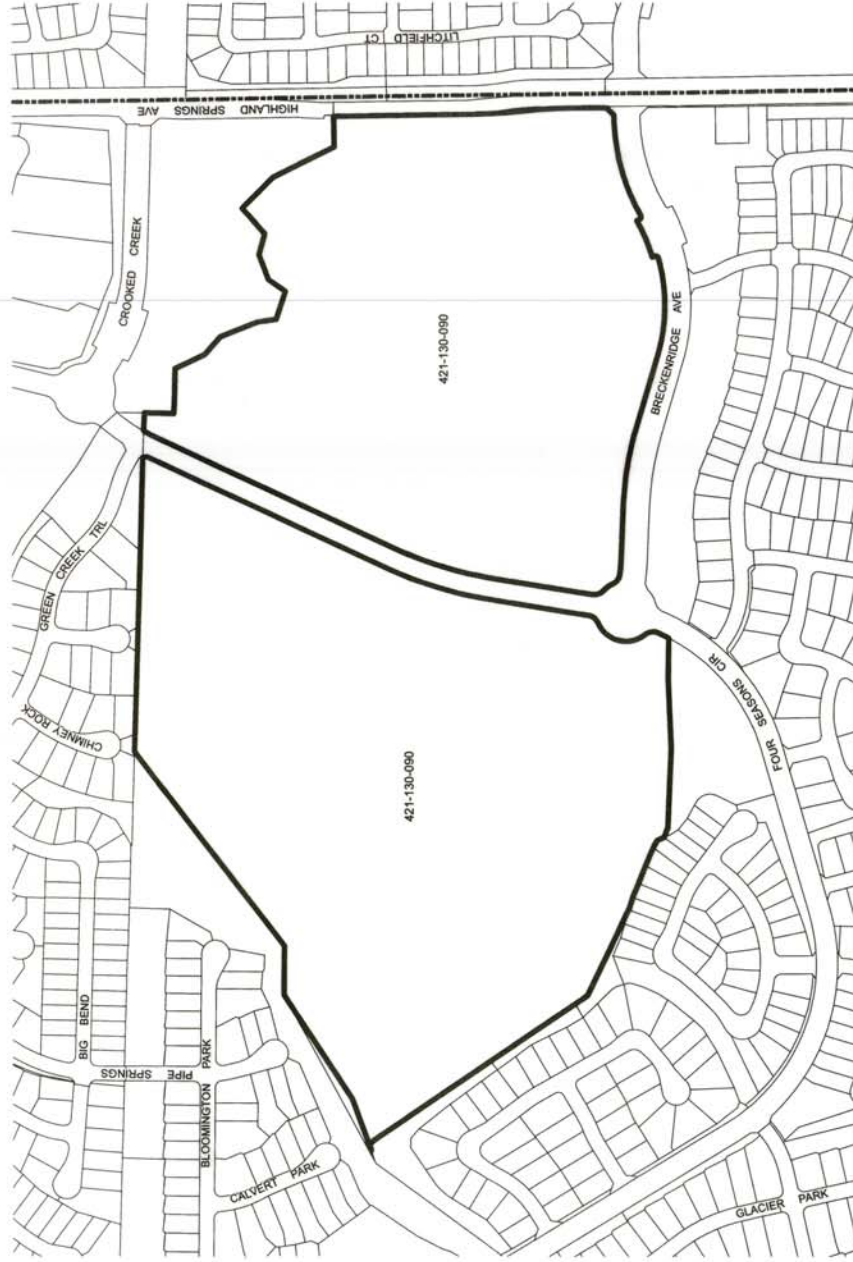

**LEGEND**

- CFD BOUNDARY
- PARCEL LINE
- BEAUMONT CITY BOUNDARY
- ASSESSOR'S PARCEL NUMBER

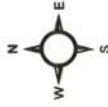

I HEREBY CERTIFY THAT THE WITHIN MAP SHOWING PROPOSED BOUNDARIES OF COMMUNITY FACILITIES DISTRICT NO. 2016-4, CITY OF BEAUMONT, COUNTY OF RIVERSIDE, STATE OF CALIFORNIA, WAS APPROVED BY THE CITY COUNCIL OF THE CITY OF BEAUMONT, RIVERSIDE COUNTY AT A REGULAR MEETING THEREOF HELD ON THE 18 DAY OF OCTOBER, 2016, BY RESOLUTION NO. 2016-29

*[Signature]*  
 CITY CLERK  
 CITY OF BEAUMONT

FILED IN THE OFFICE OF THE CITY CLERK, CITY OF BEAUMONT, THIS 18 DAY OF OCTOBER, 2016.

*[Signature]*  
 CITY CLERK  
 CITY OF BEAUMONT

RECORDED THIS 26<sup>th</sup> DAY OF OCTOBER, 2016 AT THE HOUR OF 1:19 O'CLOCK P.M. IN BOOK 80 PAGE 16 OF MAPS OF ASSESSMENT AND COMMUNITY FACILITIES DISTRICTS IN THE OFFICE OF THE COUNTY RECORDER, IN THE COUNTY OF RIVERSIDE, STATE OF CALIFORNIA.

SEE: \$10.00 NO.: 2016-0471009  
 PETER ALDANA, ASSESSOR, COUNTY CLERK, RECORDER

BY: *[Signature]*  
 DEPUTY

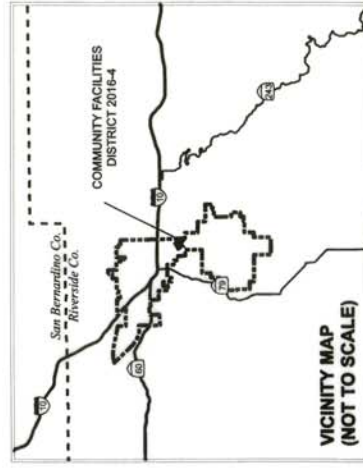

**VICINITY MAP (NOT TO SCALE)**

ALBERT A. WEBB ASSOCIATES ENGINEERING CONSULTANTS  
 THIS BOUNDARY MAP CORRECTLY SHOWS THE BOUNDARIES OF THE COMMUNITY FACILITIES DISTRICT. PARCEL NUMBERS ARE RIVERSIDE COUNTY ASSESSOR'S PARCEL NUMBERS. FOR DETAILS CONCERNING THE LINES AND DIMENSIONS OF LOTS OR PARCELS REFER TO THE COUNTY ASSESSOR'S MAPS FOR FISCAL YEAR 2016-2017.